



## Industrial Range

### For viscous products that flow

Kecol manufactures a range of Air Powered Piston Pumps to suit standard as well as non-standard Drums, Containers or IBC's. Maximum delivery output and pressure 45 L/Min. and 150 Bar.

### Features & Benefits

- Variable Output and pressure
- Can be stalled without damage
- Carbon Steel or 316 Stainless Steel contact parts
- Standard Painted Finish Industrial Range
- Quick Release Coupling between Air Motor & Pump Tube

### Typical Applications

**Chemical & General Industrial** Adhesives, colorants, resin, plasticizer, printing inks, sealants, paints, adhesives, dye, latex, oils, plasticols, etc

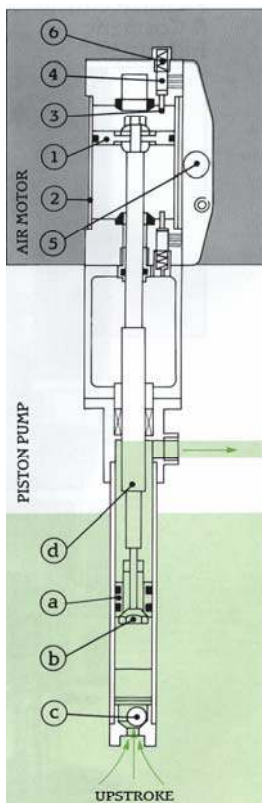

### Air Motor Operation

As piston (1) moves upward in the cylinder (2) it strikes actuator pin (3) which operates pilot valve (4). The pilot valve then signals the main spool valve (5) which redirects the air supply to the top of cylinder, causing piston to move downwards. The actuator pin and pilot spool valve are repositioned by the spring (6) and pilot air to main spool is exhausted. As piston strikes lower actuator pin a similar sequence commences giving a reciprocating action.

### Pump operation Upstroke

As upstroke begins piston (a) seats on piston nut (b) and foot valve ball (c) is lifted from its seat by product passing into pump tube.

### Downstroke

As the downstroke begins foot valve ball © seats and piston (a) is lifted clear of the piston nut (b) to allow product to pass to outlet. At bottom of downstroke a volume of product is discharged by the additional volume of the packing rod (d) entering the pump tube. On the subsequent upstroke the piston travelling upwards discharges half of the volume drawn in during the previous upstroke. Simultaneously product is drawn into the pump tube through the foot valve for the next pumping cycle.

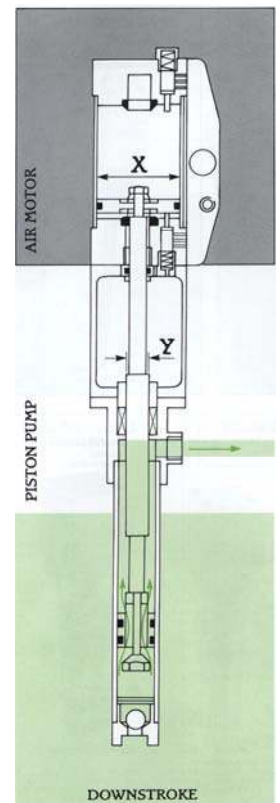

KECOL DRUM LENGTH PUMPS										
Model	Tube Material	Seal Material	Output L/Min	Ratio	Weight Kg's	Air Req'd Ltr./Min	A	B	C	D (Dia.)
8050 CND	C. St.	NITRILE	20	5:1	18	425	1445	1010	1" BSP (F)	50.8 (2")
8050 CTD	C. St.	P.T.F.E.								
8050 SND	St. St.	NITRILE								
8050 STD	St. St.	P.T.F.E.								
10050 CND	C. St.	NITRILE	20	10:1	23	623	1520	1010	1" BSP (F)	
10050 CTD	C. St.	P.T.F.E.								
10050 SND	St. St.	NITRILE								
10050 STD	St. St.	P.T.F.E.								
16050 CND	C. St.	NITRILE	20	25:1	32	1218	1520	1010	1" BSP (F)	
16050 CTD	C. St.	P.T.F.E.								
16050 SND	St. St.	NITRILE								
16050 STD	St. St.	P.T.F.E.								
10075 CND	C. St.	NITRILE	45	4:1	29	623	1520	995	1 1/2" BSP (F)	76.2 (3")
10075 CTD	C. St.	P.T.F.E.								
10075 SND	St. St.	NITRILE								
10075 STD	St. St.	P.T.F.E.								
16075 CND	C. St.	NITRILE	45	10:1	39	1218	1520	995	1 1/2" BSP (F)	
16075 CTD	C. St.	P.T.F.E.								
16075 SND	St. St.	NITRILE								
16075 STD	St. St.	P.T.F.E.								

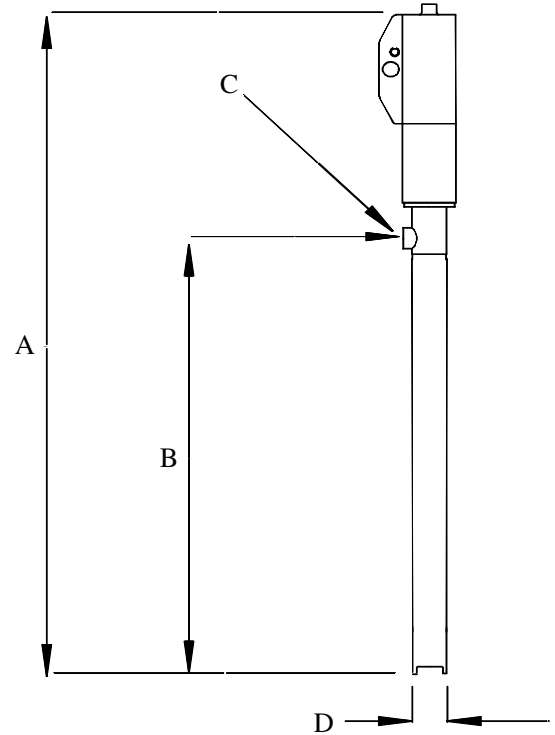

## Special Products & Accessories



Powerlift

### Powerlift series 400

This air powered Lifting Device provides a safe method of raising and lowering Kecal drum pumps into and out of drums, process containers, IBC's, mixing vessels, etc. The Powerlift, which is powered both up and down, is available in either painted steel or polished stainless steel construction and control is via a simple lever operated valve mounted on the main column of the unit.



Powerprime

### Powerprime series 500

Kecal's 'Powerprime' single pressure Priming system, used in conjunction with a Kecal Piston pump, overcomes the problems associated with semi-flowable and sticky products by providing a constant pressure on the surface of the product in the drum, which 'force feeds' the pump. As the level of the product drops, a follower plate maintains the pressure on the surface of the product and at the same time wipes the sides of the drum.



Measuring Cylinder

### Measuring Cylinders

Used in conjunction with a Kecal Piston Pump Pressure Priming System these Measuring Cylinders will dispense a predetermined volume of liquid or viscous product. They are constructed of either carbon steel or 316 stainless steel and are available in either manual or pneumatic actuation and fixed or adjustable outputs from about 200ml up to 3 Litres. Accuracy is normally better than  $\pm 1\%$ .



Special System

### Non-Standard Pumps & Systems

Whether your requirement is for a special length piston pump with a non-standard outlet fitting or a Powerlift, Powerprime or Maxiprime system for non-standard vessels, Kecal will design and manufacture a unit to suit your requirements. Our engineers will be pleased to discuss the many different options that are available such as interlocking guards, jacking or standard castors, drum loading systems, quick strip pumps, dispensing and filling systems, etc